

'NORTHPOINT ESTATE' STAGE 3

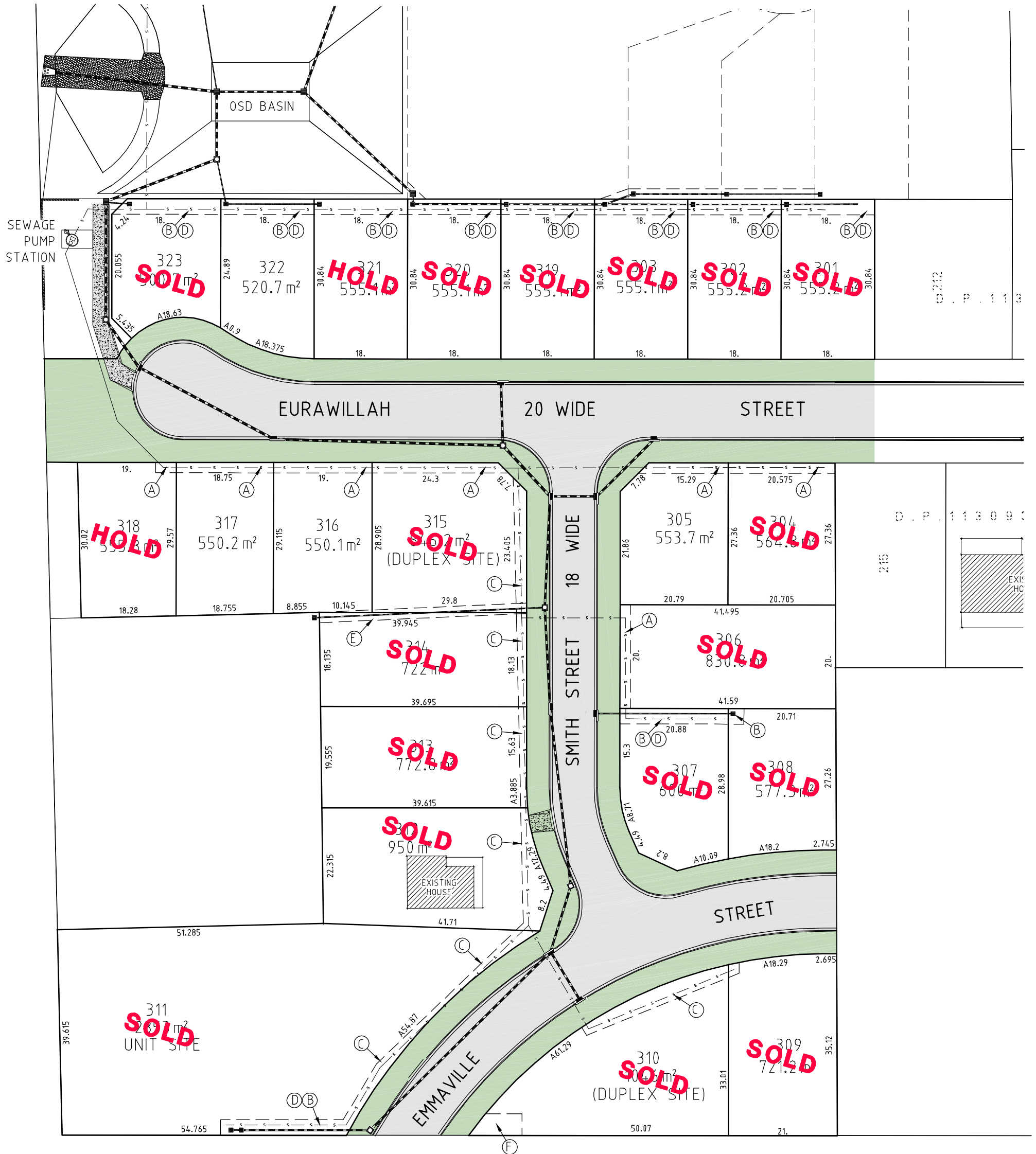
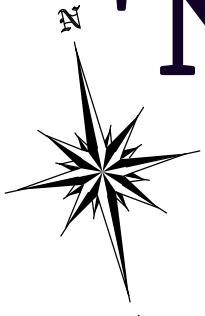

LOTS 301 TO 325
LOT 326 DEDICATED TO
COUNCIL FOR PUMP STATION

HEATH CONSULTING ENGINEERS
HENGCON PTY LTD
ACN 103 400 348

351 SUMMER STREET
PO BOX 2501
ORANGE NSW 2800

Telephone: (02) 6360 0755
Facsimile: (02) 6360 0766
Email: admin@heathce.com

5 0 5 10 15 20 25m
SCALE 1:750 (A3)

JOB No.: 06_005 STG3	DEVELOPER: FENLOR GROUP PTY LTD	REV. DATE: 30/11/15
----------------------------	---------------------------------------	------------------------

NOTES:

THIS PLAN MUST NOT BE COPIED WITHOUT THESE NOTES.

THE LOT DIMENSIONS AND AREAS SHOWN ARE SUBJECT TO SURVEY AND DETAILED ENGINEERING DESIGN.

EASEMENTS FOR SERVICES WILL AFFECT SOME LOTS. THE LOCATIONS AND SIZES OF THESE EASEMENTS IS SUBJECT TO DETAILED ENGINEERING DESIGN.

- (A) - EASEMENT TO DRAIN SEWAGE 2 WIDE
- (B) - EASEMENT TO DRAIN SEWAGE 3 WIDE
- (C) - EASEMENT TO DRAIN SEWAGE VAR. WIDTH
- (D) - EASEMENT TO DRAIN WATER 3 WIDE
- (E) - EASEMENT TO DRAIN WATER 2 WIDE
- (F) - EASEMENT FOR ELECTRICAL SUBSTATION 7x4.2